



Place.



13/27-31 Elizabeth Street Toowong QLD

3  2  2 

Located in a complex of 18 luxury residences, this light, stylish and contemporary property is perfect for those seeking a convenient and relaxed lifestyle in one of Brisbane's most sought-after inner-city suburbs. Upon entering, you'll immediately notice the light-filled kitchen, dining and lounge area, enhanced by the wide-plank timber flooring and bi-fold doors that create seamless flow to the large 30 sqm terrace.

This home features:

- Open plan living and dining
- Sleek gourmet kitchen with modern Neff appliances, gas cooking and stone benchtops
- Large outdoor, undercover entertainment terrace
- Soaring ceilings with clearstory windows providing natural light and a refined sense of space
- Spacious upper-level master suite with BIR and ensuite

**Building Size** : 135 sqm

**View** : <https://www.placeproperty.com.au/sale/qld/city-north/toowong/residential/unit/7924245>



**Sam Schmidt**  
07 3858 0388

<https://www.placeproperty.com.au>

## LOWER LEVEL

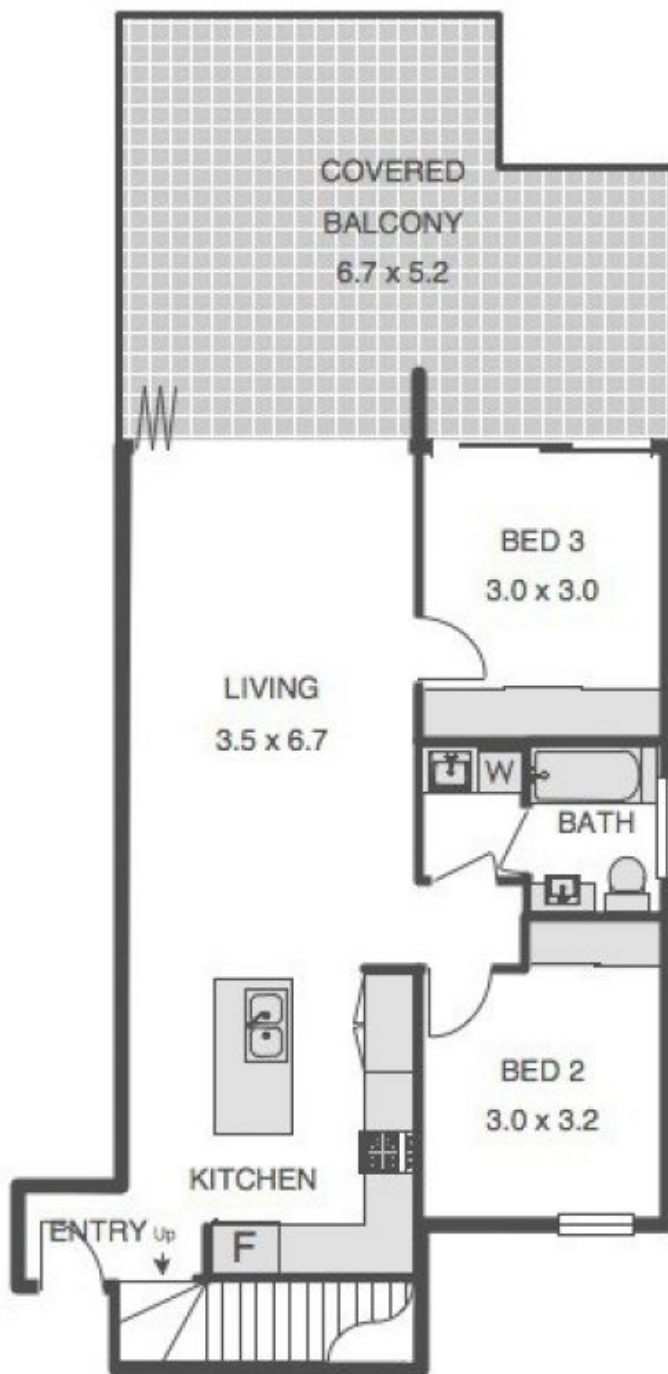

## UPPER LEVEL



2 x SECURE  
CAR SPACES  
(UNDER)

### 13/27 ELIZABETH ST TOOWONG

APPROX INTERNAL FLOOR AREA 94 sq m

APPROX FLOOR AREA INCLUDING EXTERNAL AREA 124 sq m

While every attempt is made to ensure accuracy please note that these plans are only designed to give an approximate indication of layout. All dimensions, scales, angles, location or orientation of doors, walls, windows or any other items is approximate. These plans are for representation purposes only and should not be relied upon for any purpose. No responsibility is taken for any error or mis-statement within this plan.